

# TRILOGY LIMASSOL

Cyprus

With an iconic concept by WKK, it is the height of a modern residential living in the Mediterranean, consisting of three premium high-rise buildings with offering a residential, retail and leisure experience of world-class specifications.

This cluster of three 40-storey towers is located on the southern coast of Cyprus and is configured to provide 360o vistas of the city and coast of Limassol. The towers each have a built-up area of 35,000sqm and are linked by a 2-level common podium which occupies the entire footprint of the building plot of 20,000m2. The project is set for completion in 2022.

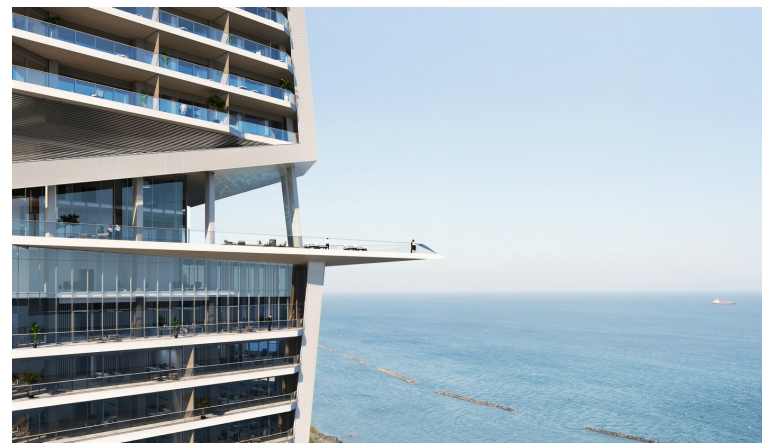

## EPPIC PARTNERS

The principals of EPPIC were involved in this project in various capacities, all of which were critical to the success of the project.

Acting on behalf of the investment shareholders, Nicos is currently the Project Director for the project and is responsible for all strategic and delivery aspects of the project, including corporate governance, authorities liaison, design, sales, marketing, development, construction, finance and accounting.

Bill and Matthew carried out the peer review and constructability consultancy for the project, focussing on developing value engineered solutions that provided an optimised design that improved the overall constructability credentials of the project. Once code compliance was verified the construction sequence was optimised to minimise floor to floor construction cycles, simplified the core layouts and reduced the material demand, all of which combine to achieve an improved programme and reduced construction costs.

## OUR APPROACH

This project is another good example of the EPPIC 'total management' approach of bringing construction intelligence to the forefront of the project planning, design and execution stages of the project.

The foresight of the construction process allowed critical decisions to be made at the planning stage which allowed the design was adjusted to achieve a simpler construction sequence. This brought benefits of time and cost which afforded the Trilogy team the necessary time to concentrate on the quality of their flagship real-estate offering.

Client: **Trilogy Limassol Seafront Ltd**

Client's Representative & Project Director:  
**Nicos Papandreou**

Value Engineering and Constructability Experts  
**Matthew J. Esther & Bill Parker**

Total Built Up Area: **135,000sqm**

Project Value: **Approx. 400m USD**